

Inspection Certificate Production and Editing Application for Surface Roughness Tester SJ-220

SJ-App V1.0



User's Manual - Instruction for use -

Read this document thoroughly before operating
the product. After reading, retain it close at hand for
future reference.

This English language version of the document
contains the original instructions.

No. 99MBB808A

Date of publication: July 1, 2023 (1)



■ Product names and model numbers covered in this document

Product name	Model number
Inspection Certificate Production and Editing Application for Surface Roughness Tester SJ-220	SJ-App V1.0

■ Notice regarding this document

- Mitutoyo Corporation assumes no responsibilities for any damage to the product, caused by its use not conforming to the procedure described in this document.
- Upon loan or transfer of this product, be sure to attach this document to the product.
- In the event of loss or damage to this document, immediately contact the agent where you purchased the product or a Mitutoyo sales office.
- Read this document thoroughly before operating the product. In particular, be sure to fully understand "Precautions for Use" on page 6.
- The contents of this document are based on information current as of August 2023.
- No part or whole of this document may be transmitted or reproduced by any means without prior written permission of Mitutoyo Corporation.
- Some screen displays in this document may be highlighted, simplified or partially omitted for convenience of explanation. In addition, some of them may differ from actual ones to the extent that no user will misunderstand the functions and operations.
- The corporation, organization and product names that appear in this document are their trademarks or registered trademarks.

©2023 Mitutoyo Corporation. All rights reserved.

Contents

Mitutoyo Application End User License Agreement	1
About This Document	4
Conventions Used in This Document	5
Precautions for Use	6
Licence of third party	6
1 Setup	7
1.1 Installation of the Application	7
1.2 Attachment of the Wireless Communication Unit for Measuring Instruments	7
2 Operating Method	9
2.1 Starting the Application and Pairing	9
2.2 List of Operations	11
2.3 Changing the Display Language	12
2.4 Displaying Calculation Results	13
2.5 Displaying the Evaluation Profile	13
2.6 Displaying BAC and ADC Profiles	14
2.7 Checking and Changing Calculation Condition Settings	15
2.7.1 Checking and Changing Measurement Condition Settings	15
2.7.2 Checking and Changing Parameter Selections	16
2.7.3 Checking and Changing Tolerance Settings	17
2.8 Recalculating Calculation Results	18
2.9 Performing Measurement	19
2.10 Reloading Data	19
2.11 Print and File Output of a Certificate of Inspection	20
2.11.1 Previewing the Print Image	20
2.11.2 Adding and Editing Comments	21
2.11.3 Showing/Hiding BAC and ADC Profiles	21
2.11.4 Changing the Header Image	22
2.11.5 Selecting the Paper Size (A4-size/Letter-size)	22
2.11.6 File Output in PDF or CSV Format	23
2.12 Saving and Reading Measurement Conditions/Measured Data	24
2.12.1 Measured Data and Measurement Conditions	24
2.12.2 Saving Measurement Conditions and Measured Data	25
2.12.3 Reading Measurement Conditions and Measured Data	26
2.13 Deleting and Renaming Measurement Conditions/Measured Data	27
2.14 Using QR Codes	28
3 Troubleshooting	31
3.1 Troubleshooting	31
3.2 Error Messages	32

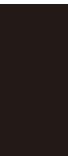

Mitutoyo Software End User License Agreement

■ IMPORTANT

PLEASE READ THIS MITUTOYO SOFTWARE END USER LICENSE AGREEMENT ("EULA") CAREFULLY BEFORE USING THE MITUTOYO SOFTWARE PRODUCTS. THIS EULA SHALL CONSTITUTE A LEGAL AGREEMENT BETWEEN YOU/CUSTOMER AND MITUTOYO CORPORATION ("MITUTOYO") FOR THE MITUTOYO SOFTWARE PRODUCT DISTRIBUTED WITH THIS EULA, WHICH SOFTWARE PRODUCT INCLUDES, WITHOUT LIMITATION, COMPUTER PROGRAM AND MAY ALSO INCLUDE ASSOCIATED MEDIA, PROGRAM DISK(S), DONGLES, MANUALS, OTHER PRINTED MATERIALS, AND/OR OTHER "ONLINE" OR ELECTRONIC DOCUMENTATION (COLLECTIVELY, "SOFTWARE PRODUCT"). BY CLICKING ON THE "ACCEPT" BUTTON, OPENING THE PACKAGE, DOWNLOADING THE SOFTWARE PRODUCT, INSTALLING THE SOFTWARE PRODUCT ON AND/OR USING A PRODUCT OR PROGRAM CONTAINED IN THE SOFTWARE PRODUCT, YOU ARE DEEMED TO HAVE CONSENTED TO BE BOUND BY THE TERMS OF THIS EULA. IF YOU DO NOT AGREE TO ALL OF THE TERMS AND CONDITIONS OF THIS EULA, DO NOT CLICK ON THE "ACCEPT" BUTTON AND DO NOT OPEN, DOWNLOAD, INSTALL OR USE THE SOFTWARE PRODUCT. THIS SOFTWARE PRODUCT IS LICENSED, NOT SOLD, SUBJECT TO THE TERMS AND CONDITIONS SET FORTH IN THIS EULA. THE GRANT OF LICENSE SET FORTH BELOW WILL BE EFFECTIVE ONLY WHEN YOU AGREE TO ALL TERMS AND CONDITIONS SET FORTH IN THIS EULA.

■ License

Mitutoyo grants to you/customer ("Customer") a non-transferable and non-exclusive and limited license to install and use one copy of the software Product (in object code form only) on a single computer system, under the terms and conditions of this EULA. In the event that Customer wishes to use the software Product on another computer, Customer must obtain another license therefor.

Customer acknowledges and agrees that (a) Mitutoyo, its affiliated and related companies and/or its suppliers are and shall remain the owner of the exclusive right, title and interest in and to the software Product and (b) Customer has no right, title or interest of any nature whatsoever in and to the software Product, except the right to use the software Product in accordance with and subject to the terms and conditions of this EULA. All rights not expressly granted herein by Mitutoyo are reserved by Mitutoyo for the exclusive benefit and use of Mitutoyo and its affiliated and related companies as Mitutoyo deems appropriate.

■ Restrictions

EXCEPT AS EXPRESSLY AUTHORIZED HEREIN, CUSTOMER SHALL NOT PRINT OR COPY, IN WHOLE OR IN PART, THE SOFTWARE PRODUCT; MODIFY THE SOFTWARE PRODUCT; REVERSE COMPILE OR REVERSE ASSEMBLE/ENGINEER ALL OR ANY PORTION OF THE SOFTWARE PRODUCT; OR RENT, LEASE, SUBLICENSE, DISTRIBUTE, SELL, OR CREATE DERIVATIVE WORKS OF THE SOFTWARE PRODUCT.

Customer may permanently transfer all of its rights under this EULA and the software Product, on the conditions that (a) Customer notifies Mitutoyo of its intention of transfer prior to such transfer; (b) Customer retains no copies thereof, (c) Customer transfers all of the software Product (including all component parts, the media and printed materials, any upgrades, this EULA, and, if applicable, the Certificate of Authenticity) to the transferee and (d) the transferee agrees to abide by all of the terms of this EULA. If the software Product is an upgrade, any transfer must include all prior versions of the software Product and all of Customer's rights therein, if any.

■ Copyright

Copyright in and to the software Product shall remain exclusively with Mitutoyo, its affiliated and related companies and/or its suppliers. Customer may not remove, modify or alter any copyright, trademark or any other intellectual property legend/notice from any part of the software Product.

■ Limited warranty

If Customer discovers a physical defect in the media on which the software Product is distributed, or in a documentation of the software Product within one year from the date of original purchase by Customer, Mitutoyo will replace the media or documentation free of charge. Except for the foregoing, the software Product is provided "AS IS"; provided however, that if a malfunction which Mitutoyo judges as fatal defect affecting an intended material performance or functions of the software Product within one year from the date of original purchase by Customer, Mitutoyo will at its option repair such defect or provide replacement application. The remedy by this limited warranty extends only to Customer as the original licensee and does not extend to the transferee. Customer's exclusive remedy and the entire liability of Mitutoyo, its affiliated and related companies and its suppliers under this limited warranty will be limited, at Mitutoyo's sole and exclusive option, only to the repair or replacement as aforesaid.

In no event does Mitutoyo warrant that the software Product is error free or that Customer will be able to operate the software Product without problems or interruptions or that the software Product will work in combination with any hardware or application application products provided by third parties.

This warranty does not apply if the software Product or any component or element thereof (or the equipment upon which such software Product is intended to operate) (a) has been altered or modified, (b) has not been installed, operated, repaired, or maintained in accordance with instructions supplied by Mitutoyo, (c) has been subjected to abnormal physical or electrical stress, misuse, negligence, or accident, or (d) is used in ultra-hazardous activities.

Any warranty provided by Mitutoyo or its affiliated companies relative to the equipment/hardware upon which the software Product is installed shall not expand, extend or otherwise modify the limited warranty set forth herein or provide any rights to Customer which are not otherwise expressly set forth herein.

EXCEPT AS SPECIFIED IN THIS WARRANTY, ALL EXPRESS OR IMPLIED CONDITIONS, REPRESENTATIONS, AND WARRANTIES OF ANY NATURE WHATSOEVER INCLUDING, WITHOUT LIMITATION, ANY IMPLIED WARRANTY OF MERCHANTABILITY, FITNESS FOR A PARTICULAR PURPOSE, NONINFRINGEMENT OR WARRANTY ARISING FROM A COURSE OF DEALING, USAGE, OR TRADE PRACTICE, ARE HEREBY EXCLUDED TO THE MAXIMUM EXTENT ALLOWED BY APPLICABLE LAW.

Customer assumes all responsibility for all results arising out of its selection of the software Product to achieve its intended results.

■ Disclaimer

IN NO EVENT WILL MITUTOYO, ITS AFFILIATED AND RELATED COMPANIES AND SUPPLIERS BE LIABLE FOR ANY LOST REVENUE, PROFIT, OR DATA, OR FOR SPECIAL, DIRECT, INDIRECT, CONSEQUENTIAL, INCIDENTAL, OR PUNITIVE DAMAGES HOWEVER CAUSED AND REGARDLESS OF THE THEORY OF LIABILITY ARISING OUT OF THE USE OF OR INABILITY TO USE OF THE SOFTWARE PRODUCT EVEN IF MITUTOYO, ITS AFFILIATED AND RELATED COMPANIES AND/OR SUPPLIERS HAVE BEEN ADVISED OF THE POSSIBILITY OF SUCH DAMAGES.

If, notwithstanding the other provisions of this EULA, Mitutoyo, its affiliated and related companies and/or its suppliers are found to be liable to Customer for any damage or loss which arises out of or is in any way connected with use of the software Product by Customer, in no event shall Mitutoyo's and/or its affiliated and related companies' and suppliers' liability to Customer, whether in contract, tort (including negligence), or otherwise, exceed the price paid by Customer for the software Product only.

The foregoing limitations shall apply even if the above-stated warranty fails of its essential purpose.

BECAUSE SOME COUNTRIES, STATES OR JURISDICTIONS DO NOT ALLOW THE EXCLUSION OR THE LIMITATION OF LIABILITY FOR CONSEQUENTIAL OR INCIDENTAL DAMAGES, IN SUCH COUNTRIES, STATES OR JURISDICTIONS, MITUTOYO'S, ITS AFFILIATED AND RELATED COMPANIES' AND SUPPLIERS' LIABILITY SHALL BE LIMITED TO THE EXTENT PERMITTED BY LAW.

■ Termination

The license of Customer under this EULA is effective until terminated. Customer may terminate this EULA at any time by destroying all copies of the software Product including all media and documentation. This EULA will terminate immediately without notice from Mitutoyo if Customer fails to comply with any provision of this EULA. Upon termination, Customer must destroy all copies of software Product including all media and documentation.

■ Export control

The software Product is subject to Japanese export control laws as well as any other applicable export or import control laws and regulations in other countries. Customer agrees to comply strictly with all such applicable regulations and acknowledges that it has the responsibility to obtain licenses to export, re-export, or import the software Product.

■ Miscellaneous

This EULA shall be governed by and construed in accordance with the laws of Japan, without giving effect to the principles of conflict of law. Customer agrees to submit to the exclusive jurisdiction of the district courts in Tokyo, Japan with respect to any dispute, controversy or claim arising out of or relating to this EULA and the parties respective rights and obligations hereunder. This EULA shall not be governed by the United Nations Convention on Contracts for the International Sale of Goods, the application which is expressly excluded.

If any portion hereof is found to be void or unenforceable, the remaining provisions of this EULA shall remain in full force and effect.

This EULA constitutes the entire agreement between Customer and Mitutoyo with respect to the subject matter hereof.

Customer shall indemnify, defend and hold harmless Mitutoyo, its affiliated and related companies and its suppliers from and against any and all claims and liability of any nature whatsoever arising out of or in connection with Customer's breach of this EULA.

The governing language of this EULA shall be English. English version will prevail to the extent that there is any inconsistency between English version and any version translated into another language.

About This Document

■ Positioning of this document, document map

This describes the positioning of this document and its relationship with other installments.

IMPORTANT

Before using SJ-Communication-Tool (referred to as "this application" in this manual), read  the separate "SJ-220 User's Manual" in advance and understand how to operate the SJ-220.

● Hardware manual

Surface Roughness Measuring Instrument SURFTEST SJ-220 Instruction Manual

Explains the safety precautions, overview, components, maintenance and inspection, troubleshooting, specifications, etc. of this product that are excerpted from the User's Manual.

Surface Roughness Measuring Instrument SURFTEST SJ-220 Cases of Troubleshooting

Explains problems that are likely to occur during measurement work, from setup work to measurement data output, and the solutions to those problems.

● Application manuals

Surface Roughness Measuring Instrument SURFTEST SJ-220 User's Manual (This document)

Explains the overview, function of each part, usage, maintenance, specifications, and troubleshooting of this product.

Surface Roughness Measuring Instrument SURFTEST SJ-220 Basic Operation Guide

The contents of the explanation focus on helping you understand the basic operations of this product. Useful functions are also introduced.

Surface Roughness Measuring Instrument SURFTEST SJ-220 Surface Roughness Parameters

Explains the roughness standards and the roughness parameters.

SJ-App
User's Manual
(This document)

Explains the procedure for importing the measurement data from the SJ-220 into a smartphone on which this application is installed and creating an certificate of inspection.

■ Intended readers and purpose of this document

● Intended readers

This document is intended for operators of the SJ-220.

The readers are assumed to have been familiar with basic operations on a smartphone and Windows.

● Purpose

The purpose of this manual is to help you to understand how to use this application to create an certificate of inspection from the data of the SJ-220 and how to edit the tolerance settings of the SJ-220 on a smartphone.



Conventions Used in This Document

■ Safety reminder conventions warning against potential hazards

NOTICE

Indicates a situation which, if not avoided, **may result in property damage.**

■ Conventions indicating referential information or reference location

IMPORTANT	Indicates information that must be known when using the product.
Tips	Indicates further information and details relevant for the operating methods and procedures that are explained in that section.
	Indicates reference location if there is information that should be referred to in this document or an extraneous User's Manual. Example: For details about XX, see  "1 Appellations for Each Part" on page A-5 in "Part A Overview".

■ Other conventions

(): Round brackets	Represent a paraphrase of an immediately preceding phrase or a supplementary explanation.
" ": Double quotation marks	Represent a highlighted phrase. They also indicate an index where information to be referenced is described.
[]: Square brackets	Represent a menu name on the screen, screen name, dialog name, button, display item, tab name, or key on the keyboard. They also indicate an item to be purposely entered or selected by the customer.
, , 1, 2, 3, ...	Indicates the order and the contents of tasks. (: indicates main tasks, 1: indicates detailed tasks)
»	Indicates the action resulted from some operation(s).

Precautions for Use

■ Use and handling of this application

- Use this application only for SJ-220.

Do not use this application for measuring instruments other than this product.

- This product is for creating and editing a certificate of inspection.

Do not use this application for purposes other than the above.

■ Notes on backing up important data

IMPORTANT

Important data such as measurement data should be backed up regularly to recording media.

Data stored on a PC can be damaged or lost for various reasons. Please note that we are not responsible for damage or loss of measurement data for any reason.

Third party license

- 1 Tap  on the [Home] screen.

» The main menu is displayed.

- 2 Tap [License] under the [Information].

» The license list is displayed.



1 Setup

This chapter describes the procedures from installing the application to attaching the wireless communication unit for measuring instruments.

1.1 Installation of the Application

Install the application on a smartphone*.

*Applicable smartphones: Android 12 or later (OS), compatible with Bluetooth 5.0

1 Turn on the smartphone.

2 View our website.

URL: <https://www2.mitutoyo.co.jp/eng/contact/products/SJ-App/>

3 Scan the QR code with a smartphone application to access the download site.

4 Download and install [SJ-App].

This completes the installation of the application.

1.2 Attachment of the Wireless Communication Unit for Measuring Instruments

Attach the wireless communication unit for measuring instruments to the display unit (SJ-220).

IMPORTANT

To pair (Bluetooth connection) a smartphone with SJ-220, the wireless communication unit for measuring instruments (option: Code No. 264-628) must be attached.

1 Remove the connector cover of the display unit (SJ-220).

- 1** Place your fingernail in the recess located at the top of the connector cover and push the connector cover A in the direction of arrow (1).
- 2** Open and remove the connector cover in the direction of arrow (2)

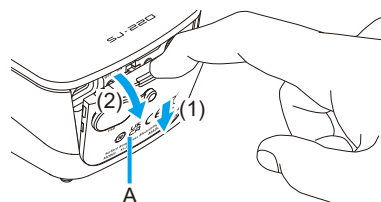

2 Insert the wireless communication unit for measuring instruments and secure it with screws (two locations).

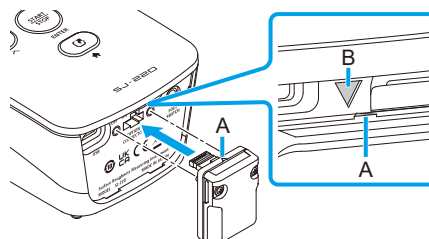

MEMO

2 Operating Method

This application loads data (measurement conditions, parameter settings, parameter results, and measured data) from the display unit (SJ-220) via the paired wireless communication unit for measuring instruments into a smartphone and displays them on the smartphone screen to create and print a inspection certificat.

The loaded data can also be edited, transferred, and saved.

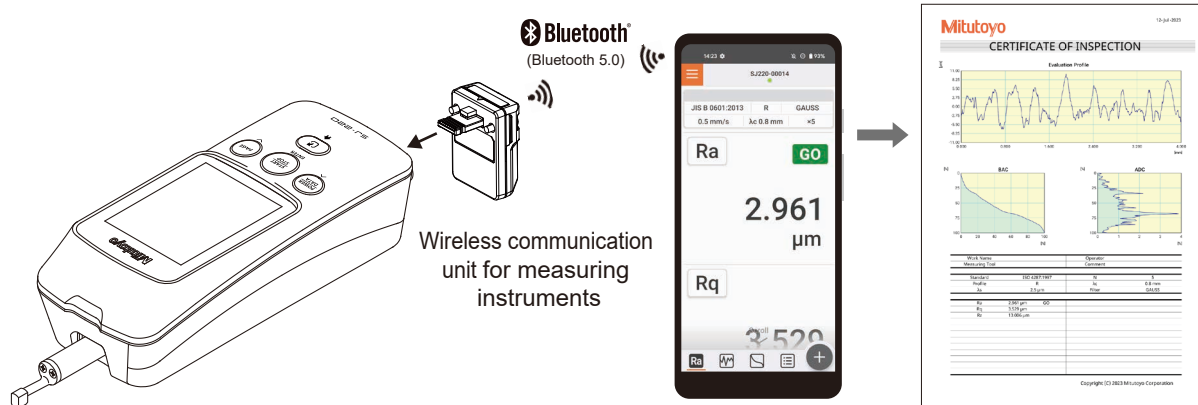

2.1 Starting the Application and Pairing

Start the application to pair (Bluetooth connection) the smartphone with the wireless communication unit for measuring instruments attached to SJ-220.

1 Start SJ-220 and then turn on the smartphone.

IMPORTANT

Be sure to turn on the smartphone while SJ-220 is activated.

Pairing may not be possible if the smartphone is turned on before SJ-220 is activated.

2 Tap [SJ-App] on the smartphone to start the application.

» The [Home] screen appears. ("*****" is displayed)

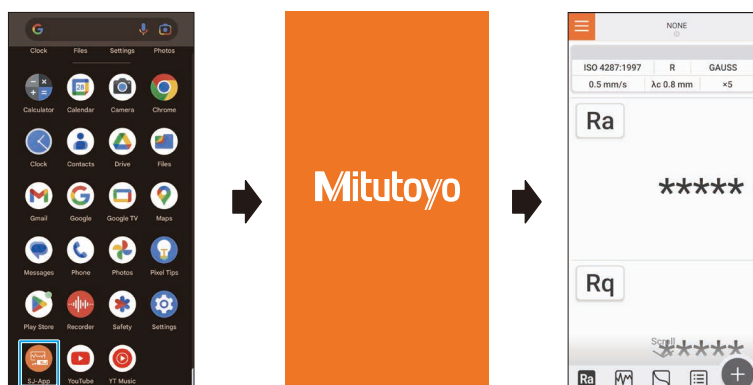

3 Pair and connect (via Bluetooth) the smartphone with SJ-220.

- 1 Tap  on the [Home] screen.
» The main menu is displayed.
- 2 Tap [Bluetooth Connection] under [Various settings].

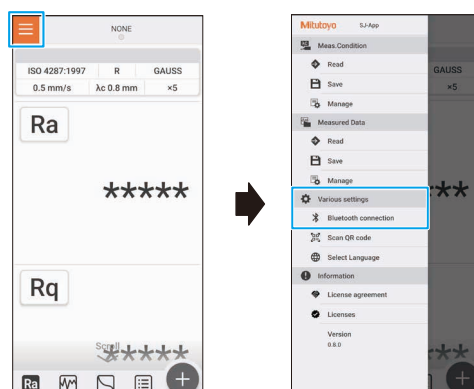

To pair and connect them for the first time

- 3 Tap [Scan] to find SJ-220 that can be paired.
- 4 Tap the name of SJ-220 to pair and enter the PIN number "193410" on the screen that appears.
- 5 Tap a selection button that has been deselected, and then tap a connection button.
» The selection button turns orange, and the connection is initiated.
- 6 Enter the ID No. indicated on the wireless communication unit for measuring instruments, and tap [OK].
- 7 Tap  to return to the [Home] screen.
» The measured data of the connected display unit is displayed.

To resume connection with the paired SJ-220

- 3 Perform only steps 5 and 7 above.

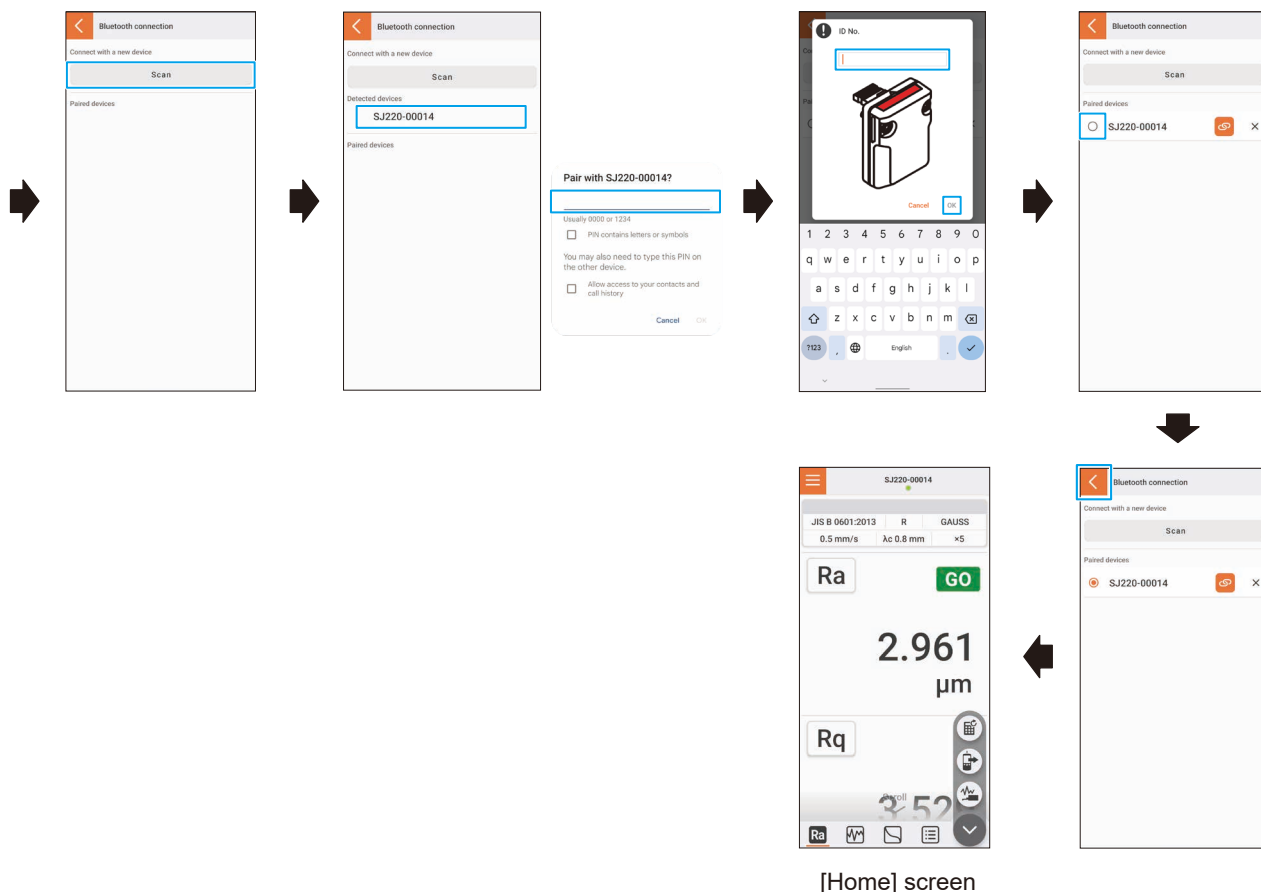

2.2 List of Operations

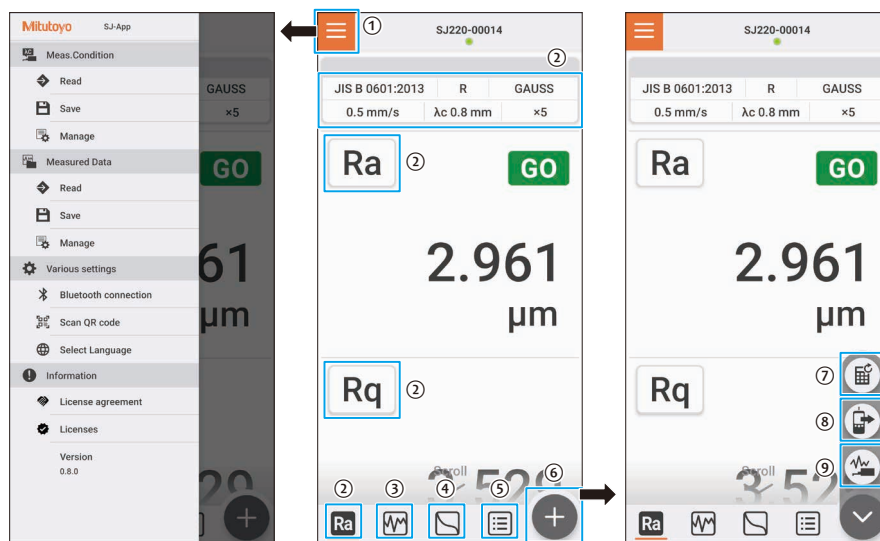

[Home] screen

Description of operation		Tap operation	Reference page
Switch the display language (25 languages supported).		① + [Select Language]	Page 12
Switch the calculation results displayed on the [Home] screen.		-	Page 13
Check and change the measurement conditions and parameters.		②	Page 15
Display the evaluation profile.		③	Page 13
Display the BAC and ADC profiles.		④	Page 14
Recalculate with the changed measurement conditions and parameters.		⑥ + ⑦	Page 18
Reload the data in the display unit (SJ-220 main unit).		⑥ + ⑧	Page 19
Perform measurement.		⑥ + ⑨	Page 19
Edit the inspection certificat.	Preview the print image.	⑤	Page 20
	Add/edit comments.		Page 21
	Show/hide the BAC and ADC profiles.		Page 21
	Change the header image.		Page 22
	Select the paper size (A4-size/Letter-size).		Page 22
	Output the file in PDF or CSV format.		Page 23
Read the measurement conditions.		① + [Read]	Page 26
Save the measurement conditions.		① + [Save]	Page 25
Manage the measurement conditions.		① + [Manage]	Page 27
Read the measured data.		① + [Read]	Page 26
Save the measured data.		① + [Save]	Page 25
Manage the measured data.		① + [Manage]	Page 27

Description of operation	Tap operation	Reference page
Enable Bluetooth connection.	① + [Bluetooth Connection]	Page 9
Scan the QR code.	① + [Scan QR code]	Page 28

Measurement conditions: Roughness standard, evaluation profile, filter, λ_s , λ_c , measuring speed (M-Speed), number of sampling lengths (N), pre-trave/post-trave (Pre/Post) ON/OFF, measurement range, etc.

Parameters: Parameter settings, tolerance judgment settings (ON/OFF, judgment rules, upper/lower tolerance values)

2.3 Changing the Display Language

This section describes the procedure for selecting and changing the display language from 25 languages.

1 Tap the icon on the [Home] screen.

» The main menu is displayed.

2 Tap [Select Language] under [Various settings].

» A list of display languages is displayed. The current display language is indicated by an orange button.

3 Tap the name of the language you want to change to and tap the icon.

» The display language switches to the language you tapped. (e.g., English)

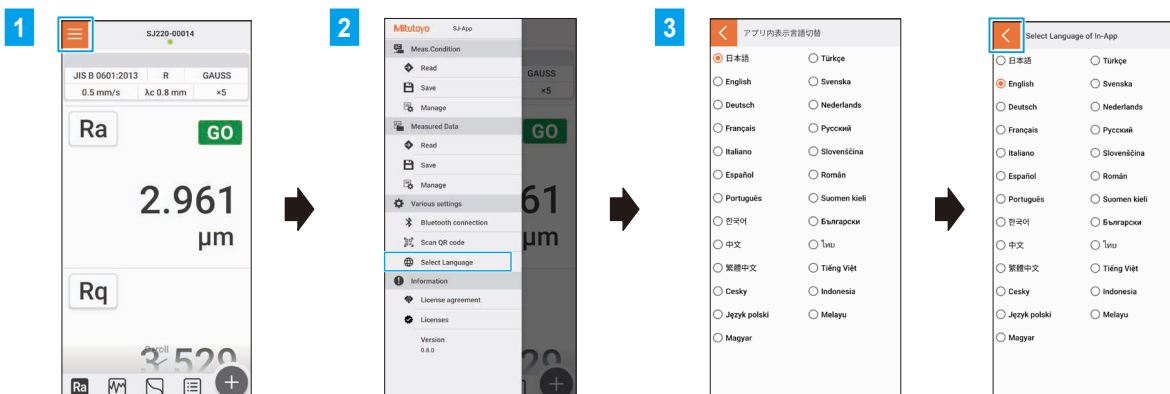

2.4 Displaying Calculation Results

The parameter calculation results are displayed on the [Home] screen.

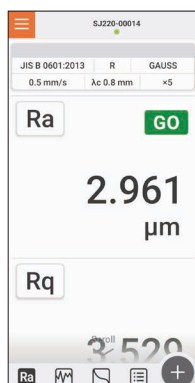

Tips

The calculation results for other parameters can be viewed by swiping the screen vertically.

Pinch in/out the screen to switch between three display sizes.

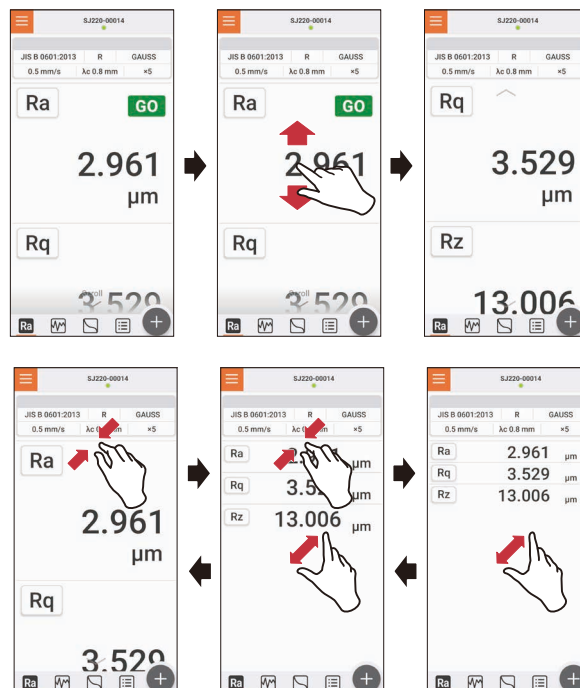

2.5 Displaying the Evaluation Profile

1 Tap on the [Home] screen.

» The evaluation profile is displayed horizontally.

2 Tap for enlarged display (vertical display).

» The evaluation profile is enlarged (displayed vertically).



To return to the [Home] screen:

Tap .

To return to horizontal display:

Tap .

2.6 Displaying BAC and ADC Profiles

1 Tap  on the [Home] screen.

» The BAC and ADC profiles are displayed horizontally.

2 Tap  for enlarged display (vertical display).

» The BAC and ADC profiles are enlarged (displayed vertically).

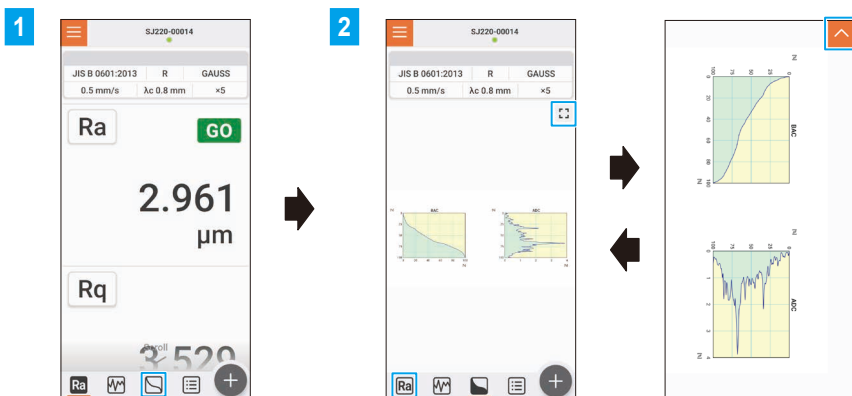

To return to the [Home] screen:

Tap .

To return to horizontal display:

Tap .

2.7 Checking and Changing Calculation Condition Settings

This section describes the procedures for changing the measurement conditions and setting parameters, tolerance values, and other calculation conditions.

2.7.1 Checking and Changing Measurement Condition Settings

This subsection describes the procedure for listing and changing the setting status of measurement conditions.

1 Tap the "displayed measurement conditions" on the [Home] screen.

» The current measurement conditions are listed.

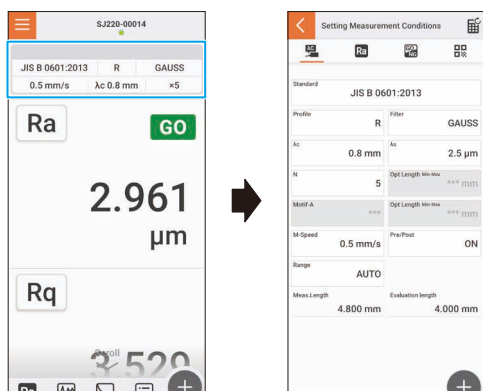

Tips

Swipe the screen left or right or tap the icon to change the selected screen (orange underbar).

- : Measurement condition setting ["2.7.1"](#) (page 15)
- : Parameter selection ["2.7.2"](#) (page 16)
- : Tolerance judgment setting ["2.7.3"](#) (page 17)
- : QR code registration ["2.14"](#) (page 28)

2 Tap the condition item you want to change (e.g., Standard).

» A list of choices is displayed.

3 Tap the item you want to change to. (e.g., ISO4287 (ISO1997))

Flip the screen to scroll the display up and down.

» The measurement condition changes to the item you tapped.

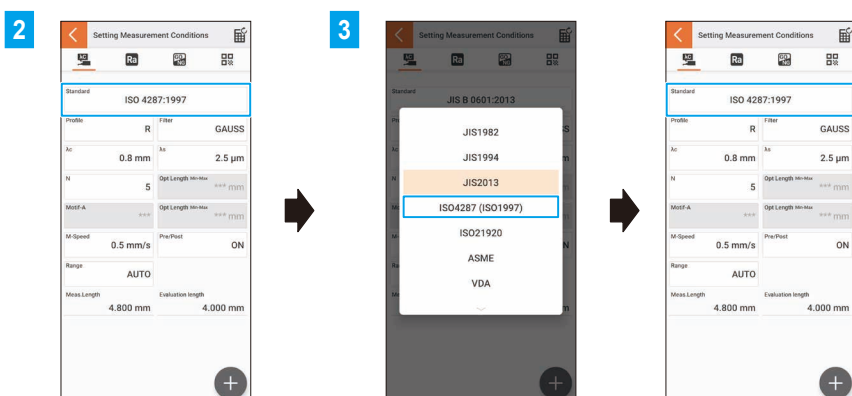

4 Perform recalculation.

IMPORTANT

Recalculation is required when the measurement conditions are changed (when the roughness standard is changed, the filter is changed, or the number of sampling lengths (N) is decreased).

For details about the operating procedure, see ["2.8"](#) (page 18).

2.7.2 Checking and Changing Parameter Selections

This subsection describes the procedure for listing and changing the parameter selection status.

1 Tap "parameter names" on the [Home] screen.

» The currently selected parameters are listed.

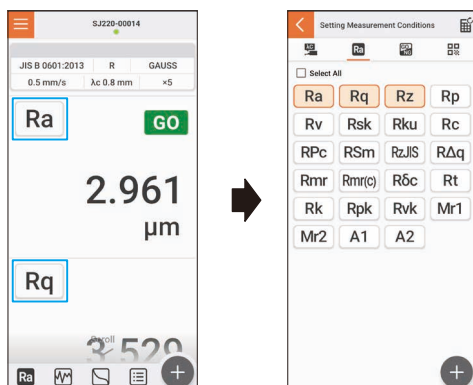

Tips

Swipe the screen left or right or tap the icon to change the selected screen (orange underbar).

- : Measurement condition setting ["2.7.1"](#) (page 15)
- : Parameter selection ["2.7.2"](#) (page 16)
- : Tolerance judgment setting ["2.7.3"](#) (page 17)
- : QR code registration ["2.14"](#) (page 28)

IMPORTANT

Details of the parameter must be set in advance on the SJ-220 itself.

For details, see ["2.4 Calculation condition setting"](#) of the SJ-220 User's Manual..

2 Tap the name of the parameter you want to change. (e.g., Rp)

» Each tap toggles between [Selected (orange)] and [Unselected (white)].

3 Tap to return to the [Home] screen.

» The selected/unselected parameters are reflected in the [Home] screen.

When additional parameters are selected, the calculation results are displayed with " ***** ".

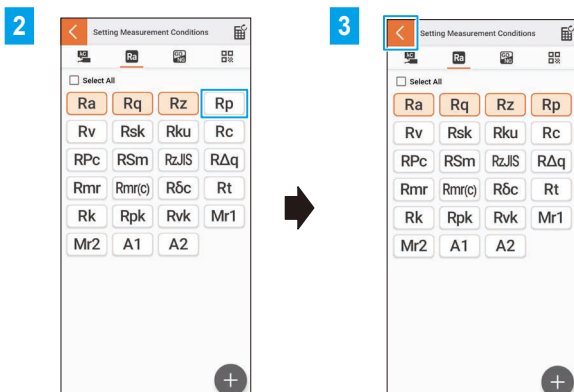

4 Perform recalculation.



IMPORTANT

Recalculation is required when parameter settings are changed.

For details about the operating procedure, see ["2.8"](#) (page 18).

2.7.3 Checking and Changing Tolerance Settings

This subsection describes the procedure for listing and changing the tolerance setting status.

- 1 Tap the "displayed measurement conditions" on the [Home] screen.
» The currently selected parameters are listed.
- 2 Swipe the screen horizontally or tap  to switch to the [Tolerance Setting] screen.
» The tolerance setting status is listed.
- 3 Tap the [Low Limit] and [Up Limit] columns, enter the desired values, and then tap .

IMPORTANT

Some smartphones may not display the minus sign on the number input keyboard. In that case, use the keyboard app for Android..

» The [Home] screen appears.

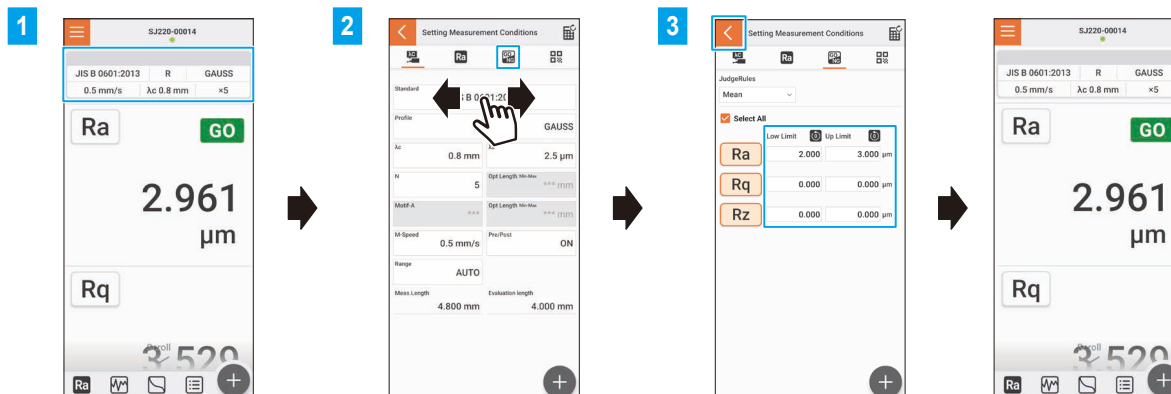

- 4 Perform recalculation.

IMPORTANT

Recalculation is required when the tolerance settings are changed.
For details about the operating procedure, see  "2.8" (page 18).

2.8 Recalculating Calculation Results

If any of the following selections or settings are changed for the measurement conditions or parameters, recalculation should be performed.

- Selection of a roughness standard
- Selection of a filter
- Selection of the number of sampling lengths (N) (if decreased)
- Selection of parameters
- Tolerance judgment and tolerance settings

1 Tap **+** on the [Home] screen.

» Additional icons are displayed.

2 Tap  among the displayed icons to perform recalculation.

» Recalculation is performed on the display unit (SJ-220), and the [Home] screen is updated. (e.g., release of the tolerance judgment)

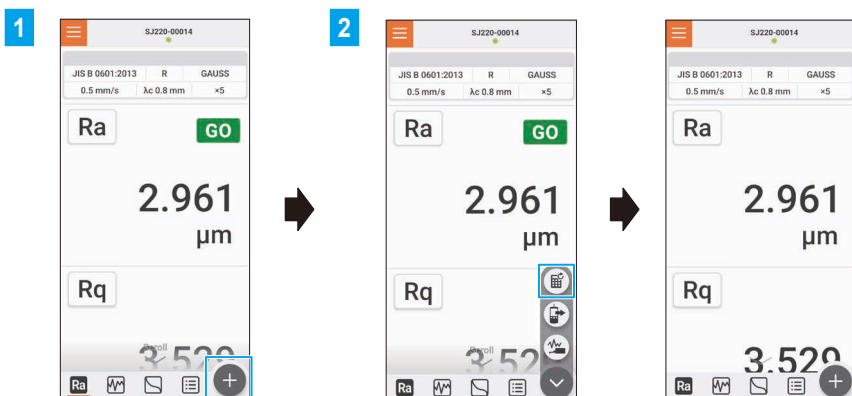

2.9 Performing Measurement

This section describes the procedure for having SJ-220 perform measurement from the application.

1 Tap  on the [Home] screen.

» Additional icons are displayed.

2 Tap  among the displayed icons to have SJ-220 perform measurement.

» SJ-220 performs measurement, and the new measurement results are displayed on the [Home] screen.

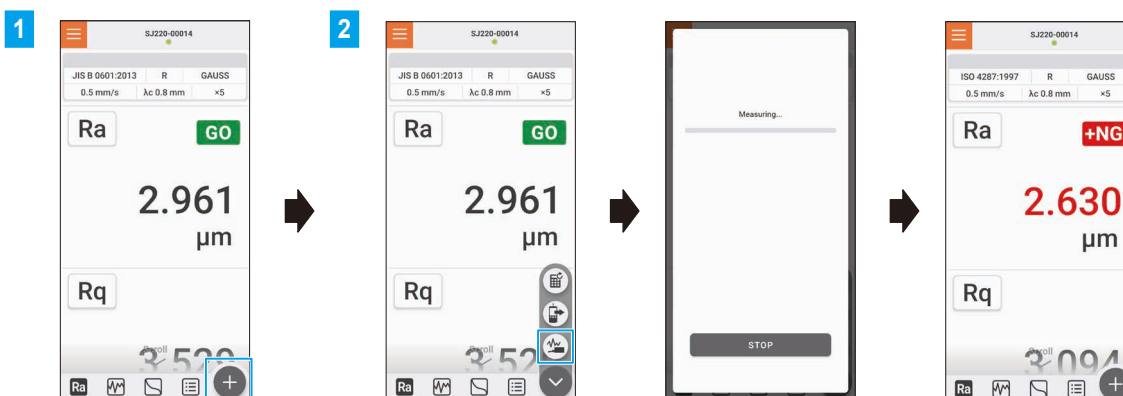

2.10 Reloading Data

This section describes the procedure for reloading the data from the display unit (SJ-220) into the application.

1 Tap  on the [Home] screen.

» Additional icons are displayed.

2 Tap  among the displayed icon to perform reloading.

» Data is newly loaded from the display unit (SJ-220), and the [Home] screen is updated.

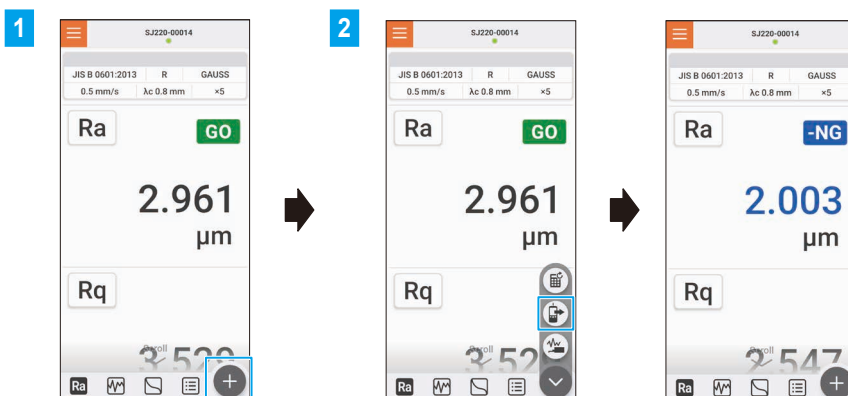

2.11 Print and File Output of a Certificate of Inspection

This section describes the procedure for previewing the print image of the inspection certificate, checking and changing the print conditions as necessary, and printing or outputting it as a file (saving it in PDF or CSV format).

IMPORTANT

Printing directly from a smartphone to a printer requires a dedicated application.

For details, please refer to your smartphone's user manual.

2.11.1 Previewing the Print Image

1 Tap  on the [Home] screen.

» The [Preview] screen appears.

2 Tap  to enlarge the image.

» The preview of the inspection certificate is enlarged.

3 Then, change print conditions or perform file output.

- Add/edit comments and display change language.
- Show/hide the BAC and ADC profiles.
- Change the header image.
- Switch the paper size (A4-size/Letter-size).
- Output a file (in PDF or CSV format).

 Continue with "2.11.2" (page 21)

 Continue with "2.11.3" (page 21)

 Continue with "2.11.4" (page 22)

 Continue with "2.11.5" (page 22)

 Continue with "2.11.6" (page 23)



To return to the [Home] screen:

Tap .

To return to the normal display screen:

Tap .

To change the print conditions:

Tap .

Change the display language of the certificate of inspection.

2.11.2 Adding and Editing Comments

The following operating instructions are a continuation of "2.11.1 Previewing the Print Image" (page 20).

1 Tap [Edit Comment].

» The [Edit comment] screen appears.

2 Enter a comment and tap .

Comments for up to four items can be entered. (e.g., workpiece name, measuring instrument, operator, comments)

» The application returns to the [Preview] screen, and the comments you have entered are displayed.

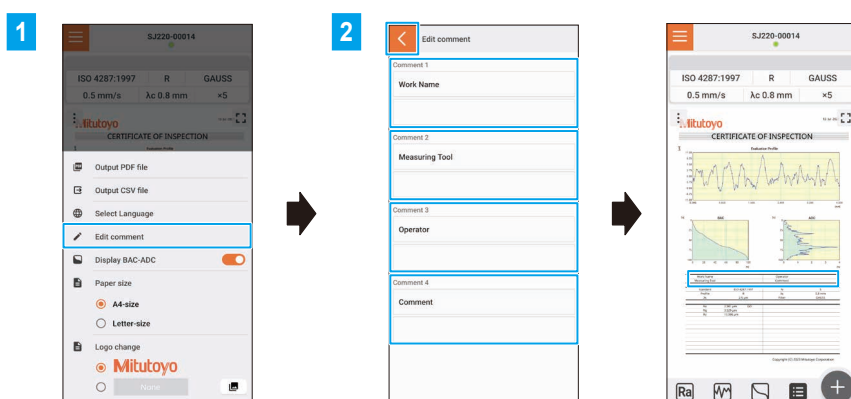

2.11.3 Showing/Hiding BAC and ADC Profiles

The following operating instructions are a continuation of "2.11.1 Previewing the Print Image" (page 20).

1 Tap the [BAC/ADC Display] ON/OFF button.

» Each tap of the button toggles ON and OFF.  indicates the ON state.

2 Tap the gray area to confirm your selection.

» The application returns to the [Preview] screen and the result of the ON/OFF selection is reflected in the display. (e.g., OFF)

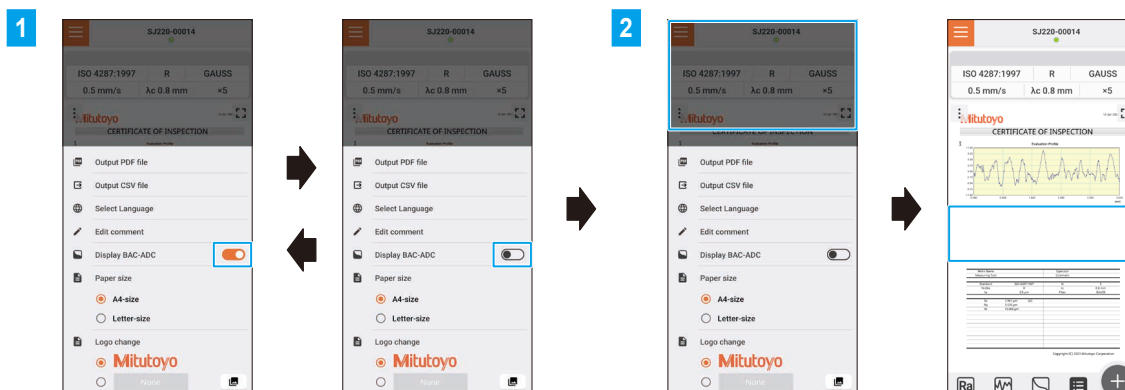

2.11.4 Changing the Header Image

This subsection describes the procedure for switching the Mitutoyo logo in the header section of the inspection certificat to an arbitrary image.

The following operating procedures are a continuation of "2.11.1 Previewing the Print Image" (page 20).

1 Tap the [Mitutoyo] or [None (optional)] button under [Logo change].

» The button for the selected item is indicated in orange.

2 If you choose "None", tap to search the saved image.

» A list of folders in the smartphone is displayed. Select the desired image.

To confirm your selection, tap the gray area.

» The application returns to the [Preview] screen.



IMPORTANT

The image files can be cropped to any size.

2.11.5 Selecting the Paper Size (A4-size/Letter-size)

This subsection describes the procedure for selecting the paper size for the inspection certificat.

The following operating procedures are a continuation of "2.11.1 Previewing the Print Image" (page 20).

1 Tap the [A4-size] or [Letter-size] button under [Paper size].

» The button for the selected item is indicated in orange.

2 Tap the gray area to confirm your selection.

» The application returns to the [Preview] screen.

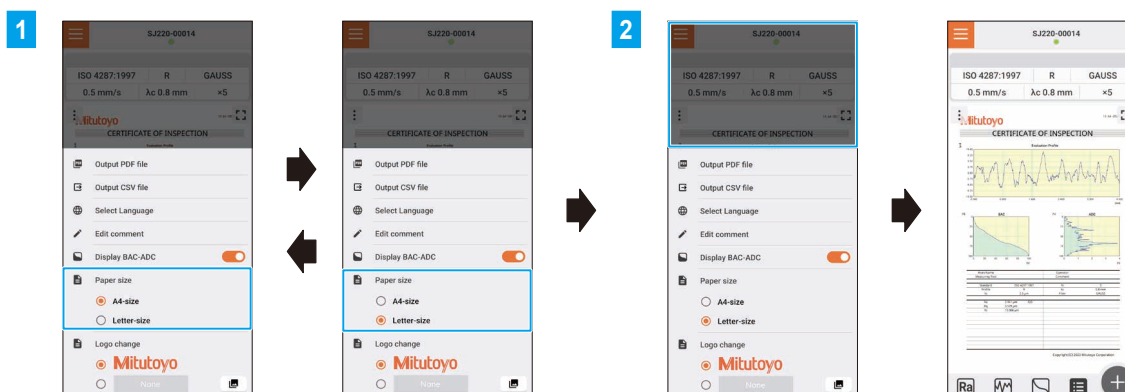

2.11.6 File Output in PDF or CSV Format

This subsection describes the procedure for outputting the inspection certificate as a file in PDF or CSV format. The following operating procedures are a continuation of "2.11.1 Previewing the Print Image" (page 20).

■ Outputting as a PDF file

1 Tap [Output PDF file].

» The [Download] screen appears.

2 Select the destination to save the file and click the [Save] button.

» The file is saved, and the application returns to the [Preview] screen.

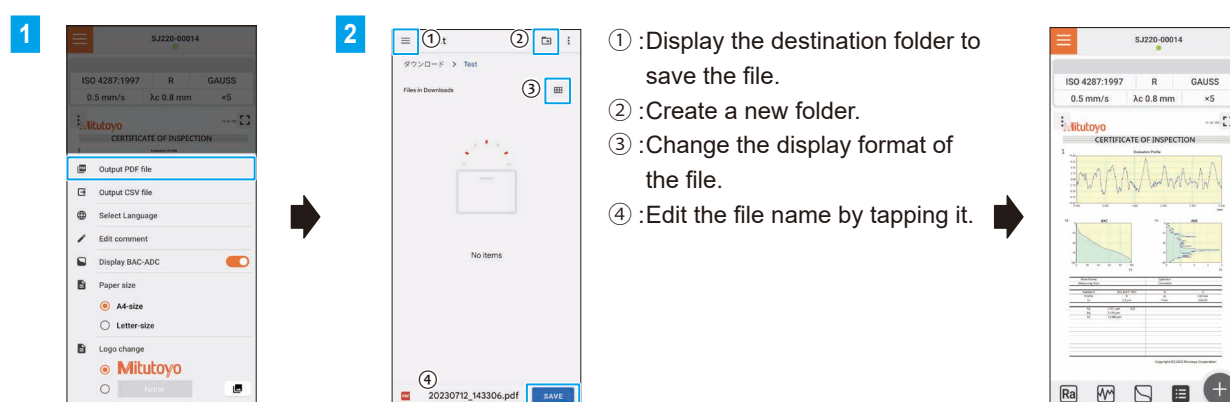

■ Outputting as a file in CSV format

1 Tap [Output CSV file].

» The [Download] screen appears.

2 Select the destination to save the file and click the [Save] button.

» The file is saved, and the application returns to the [Preview] screen.

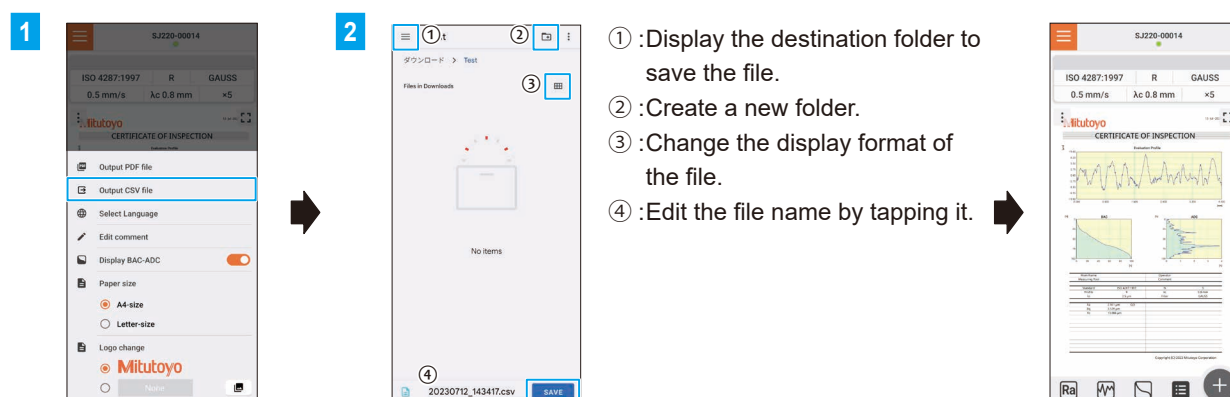

2.12 Saving and Reading Measurement Conditions/Measured Data

This section describes the procedure for saving the data (measurement conditions and measured data) loaded into the application on the smartphone and reading the data (measurement conditions and measured data) saved on the smartphone.

2.12.1 Measured Data and Measurement Conditions

Measured data and measurement conditions are managed separately in the application.

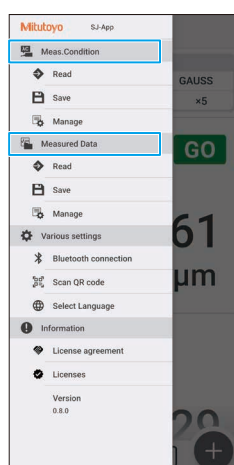

Main menu

Measured data (including measurement conditions)

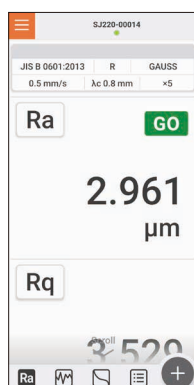

Calculation results

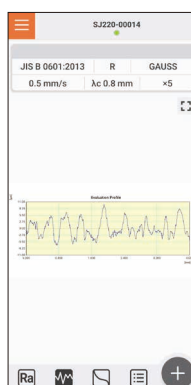

Evaluation profile

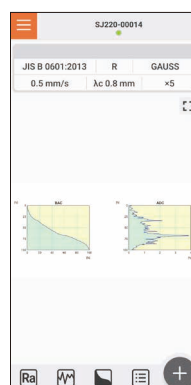

BAC and ADC profiles

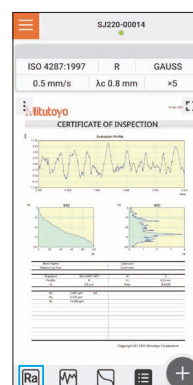

CERTIFICATE OF INSPECTION

Measurement conditions

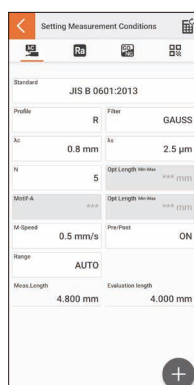

Measurement conditions

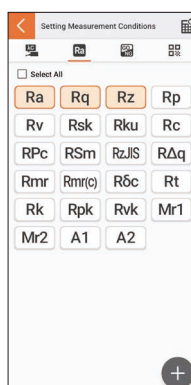

Parameters

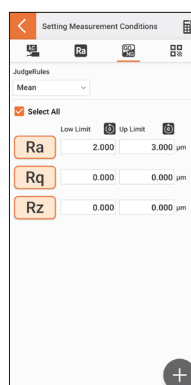

Tolerance settings

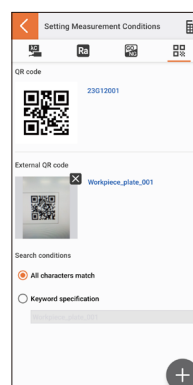

QR code

2.12.2 Saving Measurement Conditions and Measured Data

1 Tap the  icon on the [Home] screen.

» The main menu is displayed.

2 Tap [Save] under [Measurement conditions] or [Measured data].

» A list of measurement condition files or measured data files is shown. (e.g., Measurement condition files)

To overwrite an existing file

3 Tap the file to overwrite.

» The selected file is overwritten.

To save a new file

3 Save the data as a new file.

1 Tap [Save New].

2 Enter a file name and click [OK].

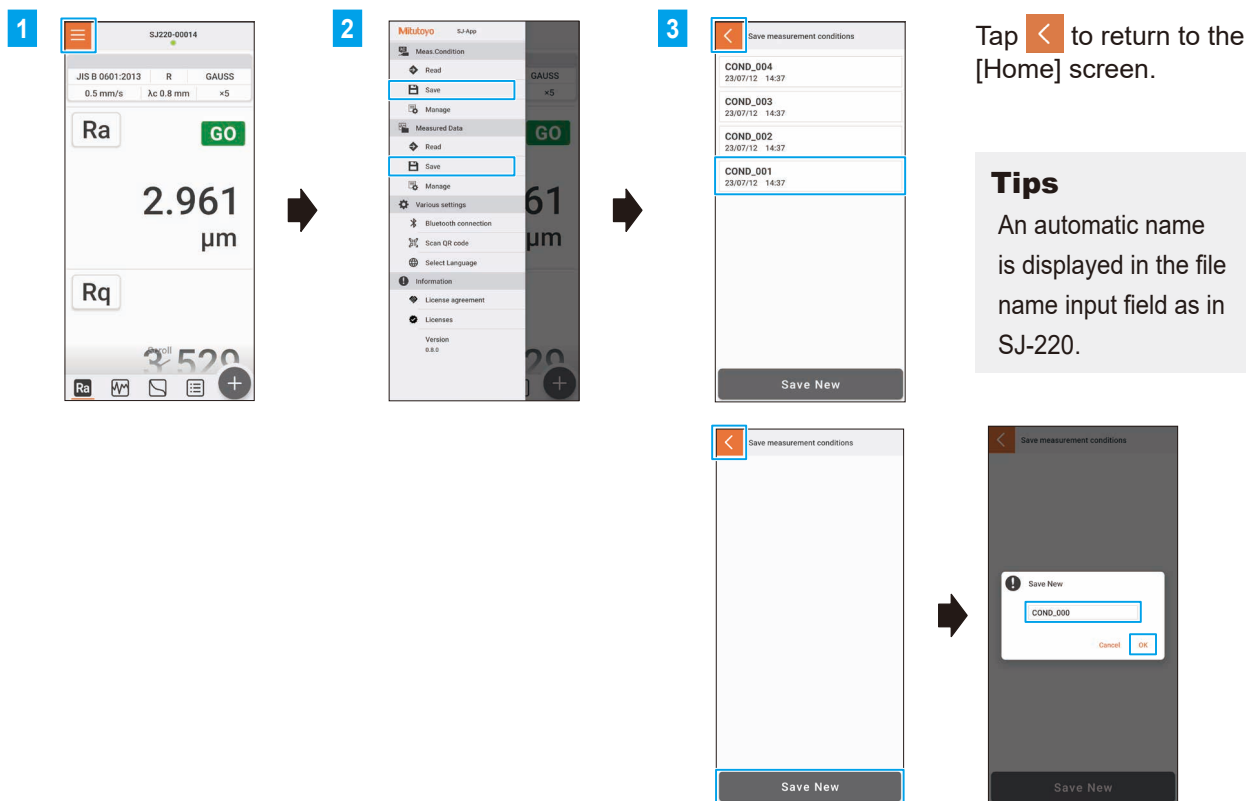

2.12.3 Reading Measurement Conditions and Measured Data

1 Tap the  icon on the [Home] screen.

» The main menu is displayed.

2 Tap [Read] under [Measurement conditions] or [Measured data].

» A list of measurement condition files or measured data files is shown. (e.g., Measured data files)

3 Tap the file to read and then tap .

» The [Home] screen is updated with the contents of the read file.

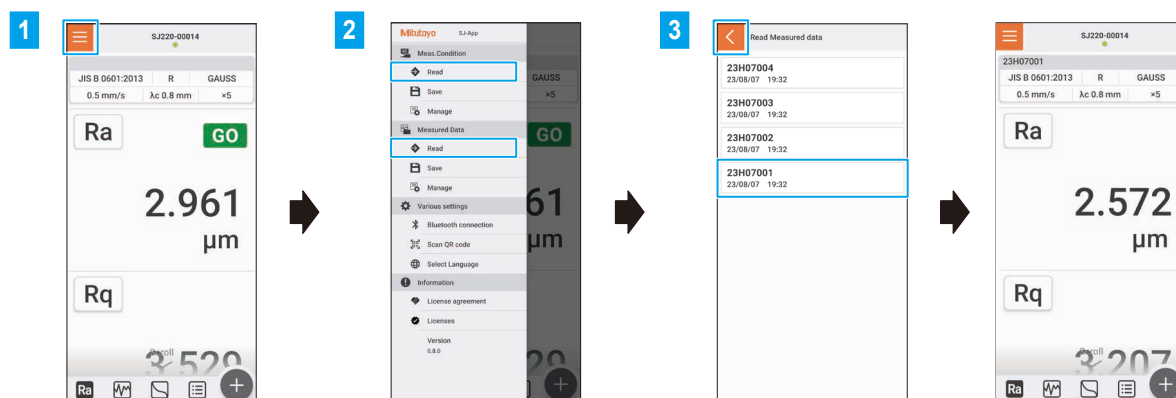

2.13 Deleting and Renaming Measurement Conditions/Measured Data

This section describes the procedure for deleting and renaming measurement condition and measured data files.

1 Tap the  icon on the [Home] screen.

» The main menu is displayed.

2 Tap [Manage] under [Measurement conditions] or [Measured data].

» A list of measurement condition files or measured data files is shown. (e.g., Measurement condition files)

3 Tap the file to delete or rename.

» [✓] appears in the check box.

To delete multiple files at once, tap the  icon.

4 Tap the  icon (delete) or the  icon (rename).

To delete a file

» The confirmation screen appears.
Tap [OK] to delete it.

To rename a file

» The name entry screen appears.
Enter a name and tap [OK].

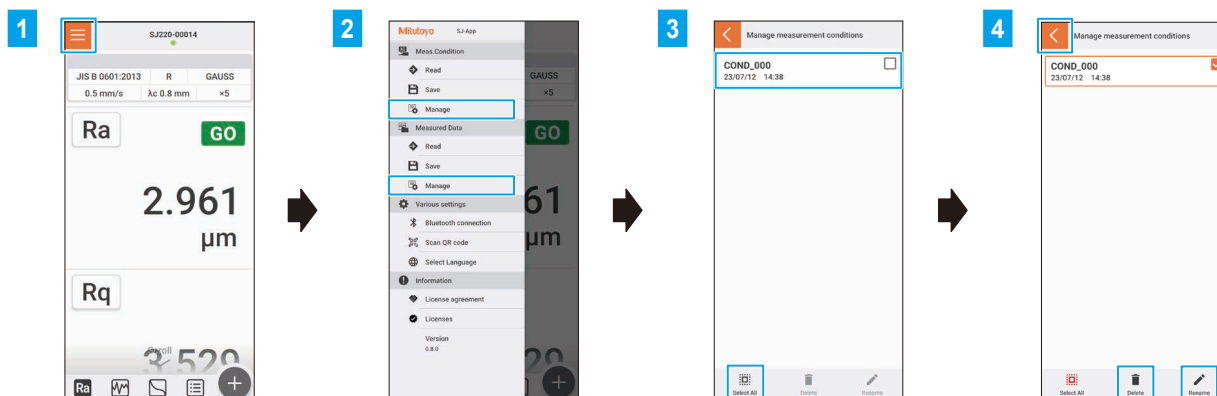

Tap  to return to the [Home] screen.

2.14 Using QR Codes

A prepared QR code can be scanned with the camera function of the smartphone and linked to measured data and measurement conditions.

A QR code is displayed on a certificate of inspection to allow, data management with the QR code.

■ Linking the QR code to the measured data

This section describes the procedure for reading the prepared QR code and linking it to the saved measured data.

Sample QR code
Workpiece_plate_001



- 1 Tap [Display Measurement Conditions] on the [Home] screen.

» The current measurement conditions are listed.

- 2 Swipe the screen horizontally or tap  to switch to the [QR Code Registration] screen.

» The [QR Code Registration] screen appears.

- QR code: representing the name of the current measured data (e.g., 23C03001)
- External QR code: scanned by the camera for registration (e.g., Workpiece_plate_001)

- 3 Tap the  icon to start the camera and read the prepared QR code.

- 4 Set the judgement conditions.

» The [Keyword] is associated with any character string by partial match. (e.g.: workpiece)

- 5 Tap  to return to the [Home] screen.

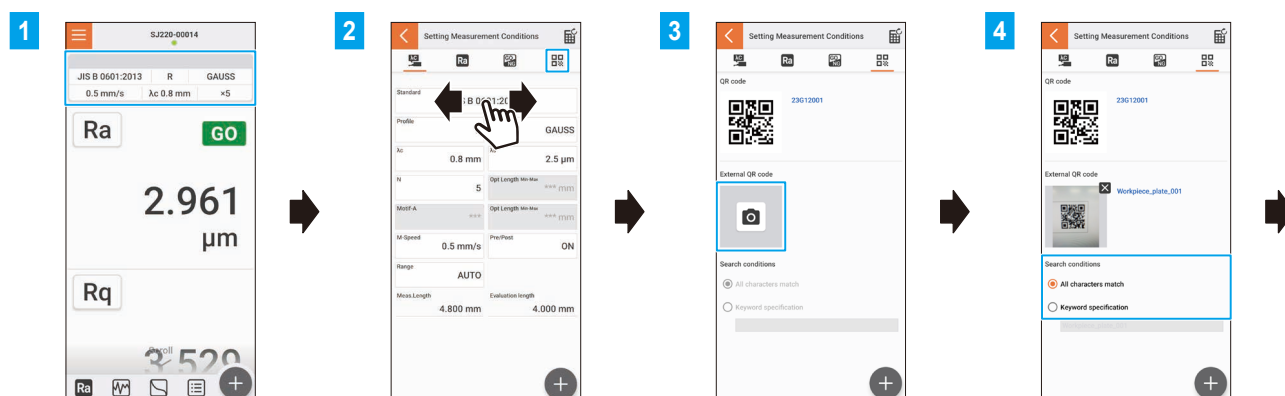

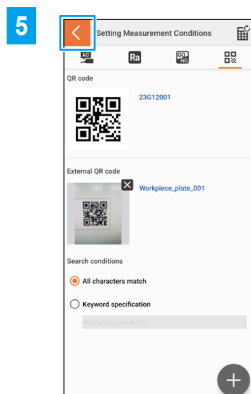

6 Tap the  icon on the [Home] screen.

7 Tap [Save] under [Measured data].

» A list of measured data files is displayed.

8 Tap the file to overwrite.

» The selected file is overwritten.

9 Tap  to return to the [Home] screen.

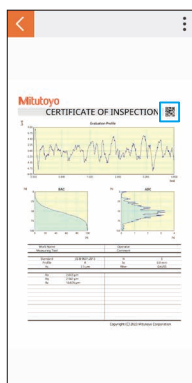

Example of QR code
display

■ Scanning the QR code to read the saved measured data

This section describes the procedure for scanning the QR code linked to the measured data and reading the saved measured data.

1 Tap the icon on the [Home] screen.

» The main menu is displayed.

2 Tap [Scan QR code] under [Various settings].

» The screen to permit scanning appears.
Upon approval, the scanning screen appears.

3 Hold the smartphone over the QR code.

Slide [] to zoom the screen.

» The scan result (name of the measured data linked to the QR code) is displayed.

4 Tap the name of the measured data.

» The measured data is read and displayed on the [Home] screen.

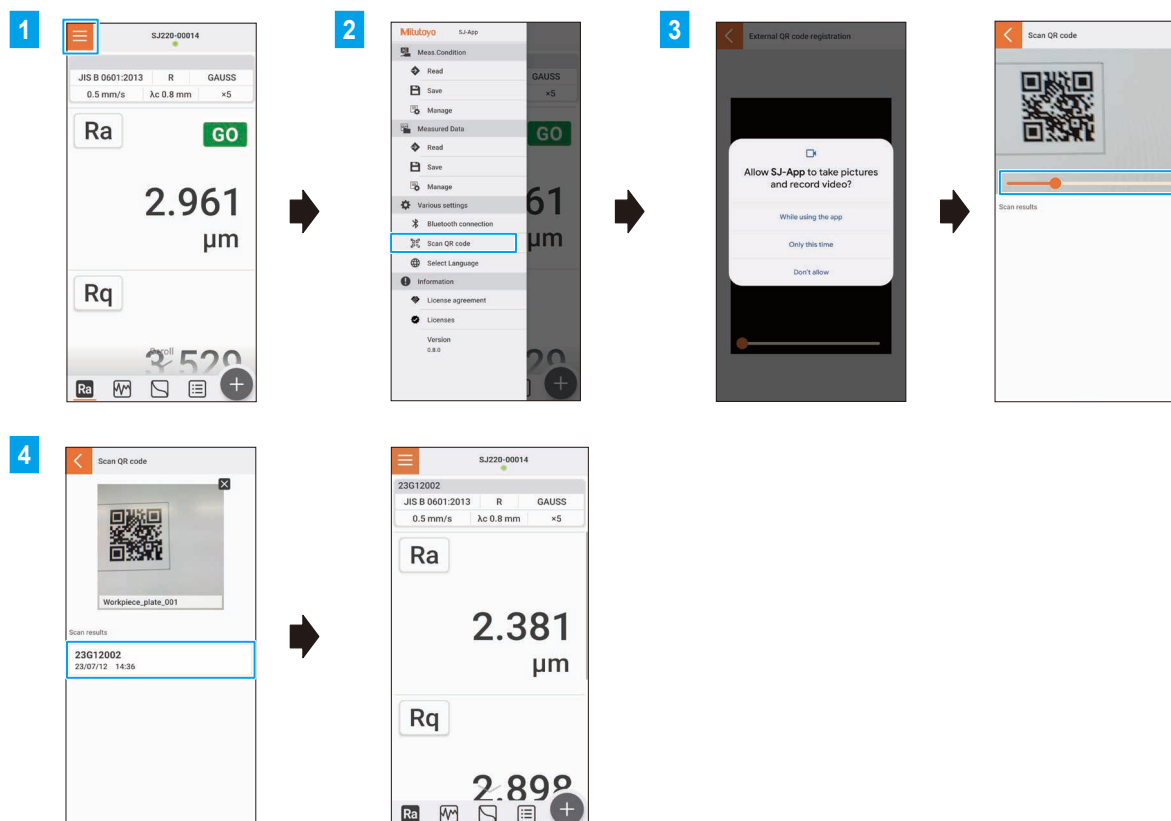

3 Troubleshooting



If you find something wrong with the operation, please read and check this chapter on troubleshooting first.

3.1 Troubleshooting

If you suspect that the application is not working properly, please read and check this chapter on troubleshooting first.



For information on how to respond to error messages that occur during operation, see  "3.2 Error Messages" (page 32).

■ The application cannot be connected online.

Point to check	Cause and solution
Is the application set up?	<ul style="list-style-type: none">• See  "1.2 Attachment of the Wireless Communication Unit for Measuring Instruments" (page 7)• See  "2.1 Starting the Application and Pairing" (page 9)• Restart the application.
Is SJ-220 set up for wireless communication?	<ul style="list-style-type: none">• See  "3.1 Wireless Communication" in the "PART F Environment Settings" of the SJ-220 User's Manual.• Restart SJ-220.

3.2 Error Messages

When an error message appears, first read and check this error message table.

Message	Cause	How to remedy
<ul style="list-style-type: none"> • Please connect via Bluetooth. • Bluetooth connection is unsuccessful. • Bluetooth field intensity is weak. 	<ul style="list-style-type: none"> • SJ-220 is turned OFF. • Bluetooth is not connected. • Bluetooth became disconnected during communication. • The PIN code and ID No. of the wireless communication unit for measuring instruments is not input correctly. • The Bluetooth signal is not strong enough. 	<ul style="list-style-type: none"> • See  "2.1 Starting the Application and Pairing" (page 9). • Bring the smartphone closer to the wireless communication unit for measuring instruments. (The situation may not improve due to the surrounding radio wave environment).
Cannot start measurement.	<ul style="list-style-type: none"> • SJ-220 is already performing measurement. • The drive unit is not connected. • The detector is not connected. • The detector is retracted. • Detector over-range • Traverse length error 	<ul style="list-style-type: none"> • See  "PART B Setting Up" of the SJ-220 User's Manual. • Press the [START/STOP] key on the measuring instrument to return the detector. • Change the measurement conditions according to the drive unit.
Unexpected error occurred. Restart App or delete the App data.	Data is corrupted.	<ul style="list-style-type: none"> • Restart the application. • Restart the smartphone. • Reinstall the application.

Revision History

Date of issue	Edition number	Details of revision
August 1, 2023	First edition	Issuance

Mitutoyo Corporation

20-1, Sakado 1-Chome, Takatsu-ku, Kawasaki-shi, Kanagawa 213-8533, Japan
Tel: +81 (0)44 813-8230 Fax: +81 (0)44 813-8231
Home page: <https://www.mitutoyo.co.jp/global.html>

For the EU Directive, Authorized representative and importer in the EU:
Mitutoyo Europe GmbH
Borsigstrasse 8-10, 41469 Neuss, Germany

For the UK Regulation, Authorized representative and importer in the UK:
Mitutoyo (UK) Ltd.
Joule Road, West Point Business Park, Andover, Hampshire SP10 3UX, UNITED KINGDOM